

INSTALLER: THESE INSTRUCTIONS CONTAIN IMPORTANT SAFETY INFORMATION AND MUST BE FORWARDED TO THE BOAT OWNER.

## **pro-trim PT1000/2000**

### REPLACEMENT TOGGLE SWITCH AND DECAL KIT

### PART NUMBER CA76431P

These Instructions describe how to replace the toggle switch in the PROTRIM® Single or Dual Bezel Switch Assembly on a boat. The Switches are designed to fit SeaStar Solutions Safe-T®, NFB, Rack & Pinion, Performance Tilt and Sea Star® Hydraulic Helms.

Step 1. Remove the plastic cover of the switch assembly by first unscrewing the operating lever with boot (counterclockwise). Then remove the face nut, and then the plastic cover (see parts list diagram, Figure 1).

Step 2. Remove the hex nut holding the switch in place. Remove switch. Disconnect wires and reattach to new switch one at a time (red to center terminal, green to top and blue to bottom terminal).

Step 3. Mount switch with hex nut.

Step 4. Reinstall the cover, face nut, and operation lever with boot on the switch assembly.

#### PARTS LIST

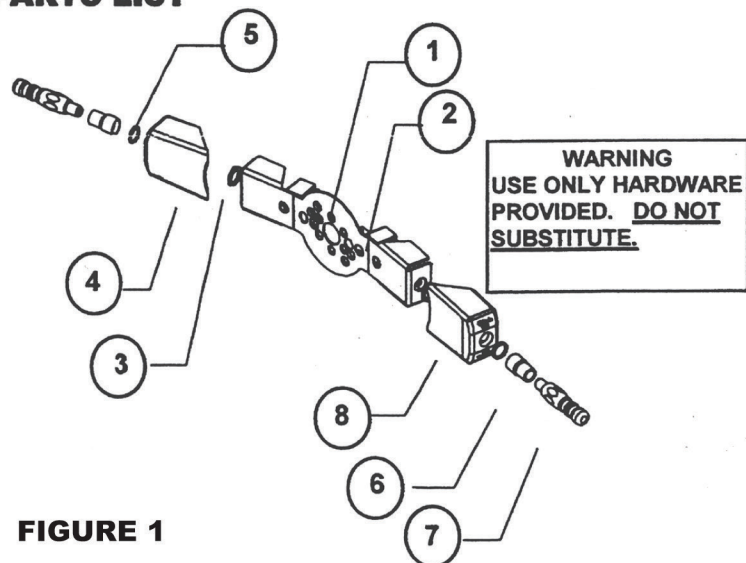

**FIGURE 1**

ITEM	DESCRIPTION	QUANTITY	
		PT1000	PT2000
1	BRACKET	1	1
2	TOGGLE SWITCH	1	2
3	HEX LOCK NUT	1	2
4	COVER	1	2
5	KNURLED FACE NUT	1	2
6	BOOT	1	2
7	OPERATING LEVER	1	2
8	DECAL SET	1	1
9*	WIRE HARNESS	1	2
10*	5/8" L. FLAT HD. SCREW	2	2
11*	7/16" L. FL. HD. SCREW	3	3
12*	#8-32 LOCK NUT	2	2
13*	5/8" SELF TAP F.H. SCR.	2	2

Item #2 and 8 included in this kit.  
\* Items not shown

# TESTING THE INSTALLATION

Test ProTrim™ to make sure it performs properly and the engine moves in the direction you expect when the switch is activated in either direction. Pushing the lever up should make the engine move upward. Pushing the lever down should make the engine move down. A test of the original trim switches should also be done at this time. If all systems work properly, make a final inspection of the wiring connections and wrap them with a good quality electrical tape.

## FINAL ADJUSTMENTS

Install the appropriate decal(s) as shown in Figure 2 (be sure plastic switch cover(s) is(are) clean and dust-free. Install the steering wheel, using the woodruff key and lock nut that was removed with the wheel. With the seat (and wheel position, if equipped with tilt) adjusted properly, try activating the switch from a normal driving grip. If the lever seems too close or too far from the steering wheel rim, this can be adjusted to suit the driver's taste. By bending this bracket slightly, the lever can be moved closer to or farther from the rim of the steering wheel.

We recommend that the driver operate ProTrim™ for some time without adjusting this bracket until he or she has determined to most suitable lever distance.

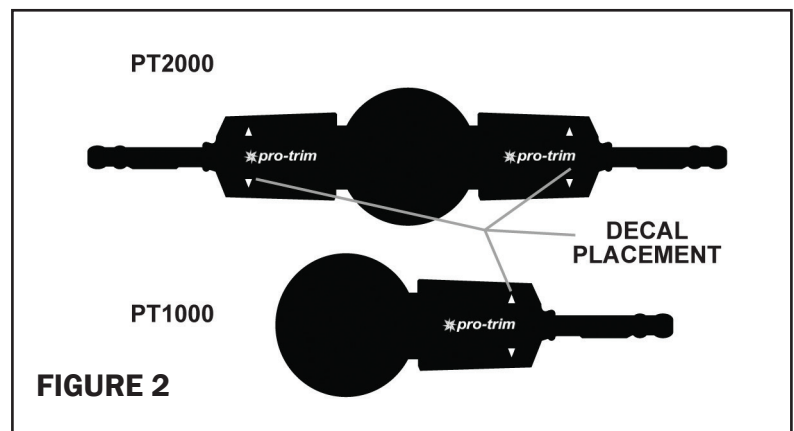

**FIGURE 2**

<u>USA Sales/Support</u> SeaStar Solutions 1 Sierra Place Litchfield, IL 62056 217-324-9781 <a href="http://www.seastarsolutions.com">www.seastarsolutions.com</a>	<u>Overseas Sales/Support</u> SeaStar Solutions International Sales and Marketing Tel: 44+1202 828010 <a href="http://www.seastarsolutions.com">www.seastarsolutions.com</a>
---	---

INSTALLER: THESE INSTRUCTIONS CONTAIN IMPORTANT SAFETY INFORMATION AND MUST BE FORWARDED TO THE BOAT OWNER.