

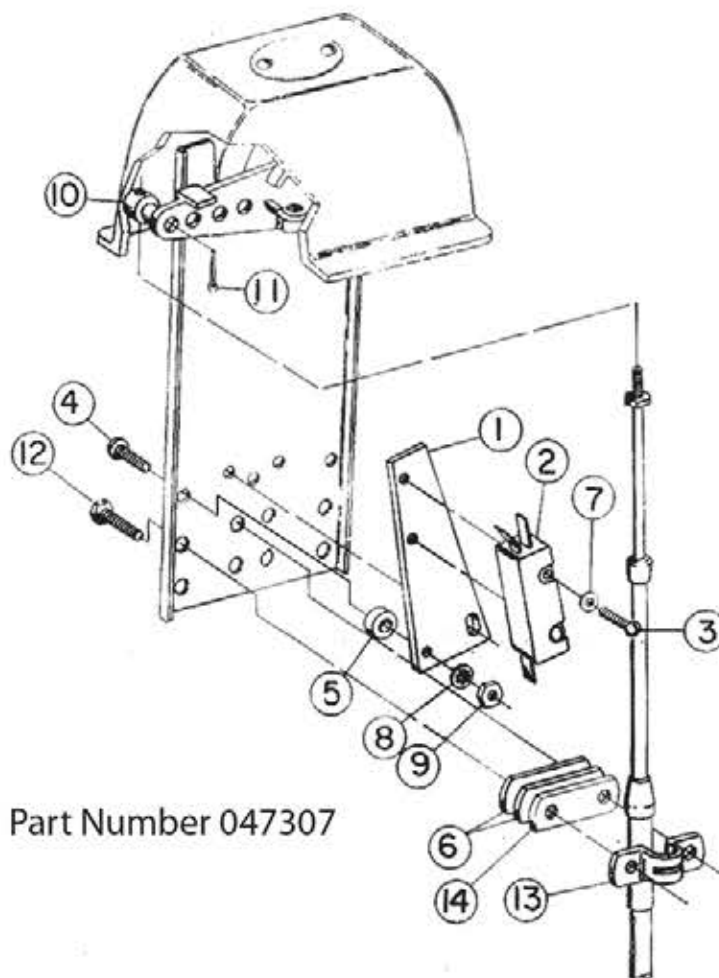

**INSTALLER: THESE INSTRUCTIONS CONTAIN IMPORTANT SAFETY INFORMATION AND MUST BE FORWARDED TO THE BOAT OWNER.**

## S- SERIES CONTROL NEUTRAL SAFETY SWITCH #047307



Part Number 047307

### NOTICE

*For use with Single S (CH5210P) or Twin S (CH5200P) Controls where cable is used in a clutch mode.*

1. Place 2 shims (6) under existing shim (14) and clamp (13) that fastens cable to hanger plate.
2. Secure bracket to control using spacers (5), screws (4), lockwashers (8) and nuts (9). DO NOT TIGHTEN AT THIS TIME.
3. Attach switch to bracket with screws (3) and lockwashers (7).

4. Adjust bracket so that cable closes switch at position nearest neutral and tighten screws.
5. Wire switch into the circuit between the starter solenoid and starter key switch. Use common and normally open terminals.

## CONTENTS

Item	Description	Req'd
1	Bracket	1
2	Switch	1
3	Screw, Rd. Hd. Slot #6-32 x 3/4" Long	2
4	Screw, Rd. Hd. Slot #10-32 x 1/2" Long	2
5	Spacer	2
6	Shim	2
7	Lockwasher, #6	2
8	Lockwasher, #10	2
9	Nut, Hex #10-32	2
-----		
10	Pivot (part of control)	--
11	Cotter Pin (part of control)	--
12	Screw, clamp (part of control)	--
13	Clamp, cable (part of control)	--
14	Shim (part of control)	--

USA Sales/Support  
SeaStar Solutions  
640 North Lewis Road  
Limerick, PA 19468  
610-495-7011  
www.seastarsolutions.com

Overseas Sales/Support  
SeaStar Solutions  
International Sales and  
Marketing  
Tel: +44 1202 828010  
www.seastarsolutions.com

**INSTALLER: THESE INSTRUCTIONS CONTAIN IMPORTANT SAFETY INFORMATION AND MUST BE FORWARDED TO THE BOAT OWNER.**