

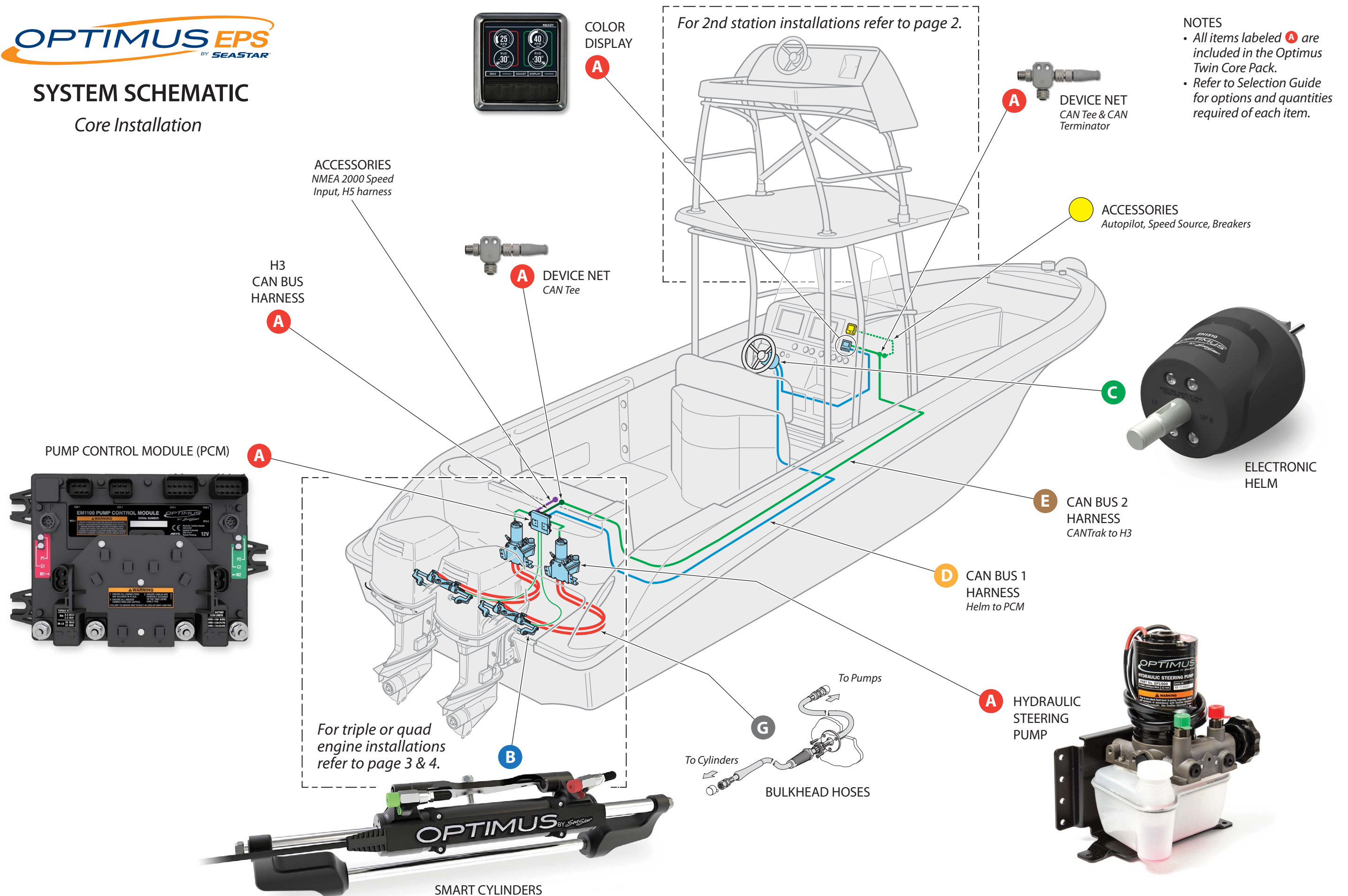

## SYSTEM SCHEMATIC

### Core Installation



- NOTES**
- All items labeled **A** are included in the Optimus Twin Core Pack.
  - Refer to Selection Guide for options and quantities required of each item.

## SYSTEM SCHEMATIC

### 2nd Station Installation



ELECTRONIC HELM



COLOR  
DISPLAY



OPTIONAL BUZZER  
Use when no  
2nd Station  
CANtrak fitted.  
(Wired to 1st Station  
CANtrak, provided  
with kit.)

TERMINATOR  
REMOVED  
FROM LOWER  
STATION BUS

TO LOWER  
STATION  
BUS

TO 2ND  
STATION  
CANTRAK/  
BUZZER



DEVICE NET  
CAN Tee

**PREFERRED**  
2nd Helm connected  
directly to unused  
PCM CAN 1 port.  
(NOTE: If harness  
exceeds 36' alternative  
daisy chained method  
MUST be used.)

#### NOTES

2nd Station  
harness lengths  
vary based on:

- Size/position of tower.
- Components installed.
- Desired location  
of tie in.

**ALTERNATIVE**  
2nd Helm daisy chained  
through lower helm.  
(NOTE: If preferred method  
cannot be accomplished.)

## SYSTEM SCHEMATIC

### *Triple Engine Application*

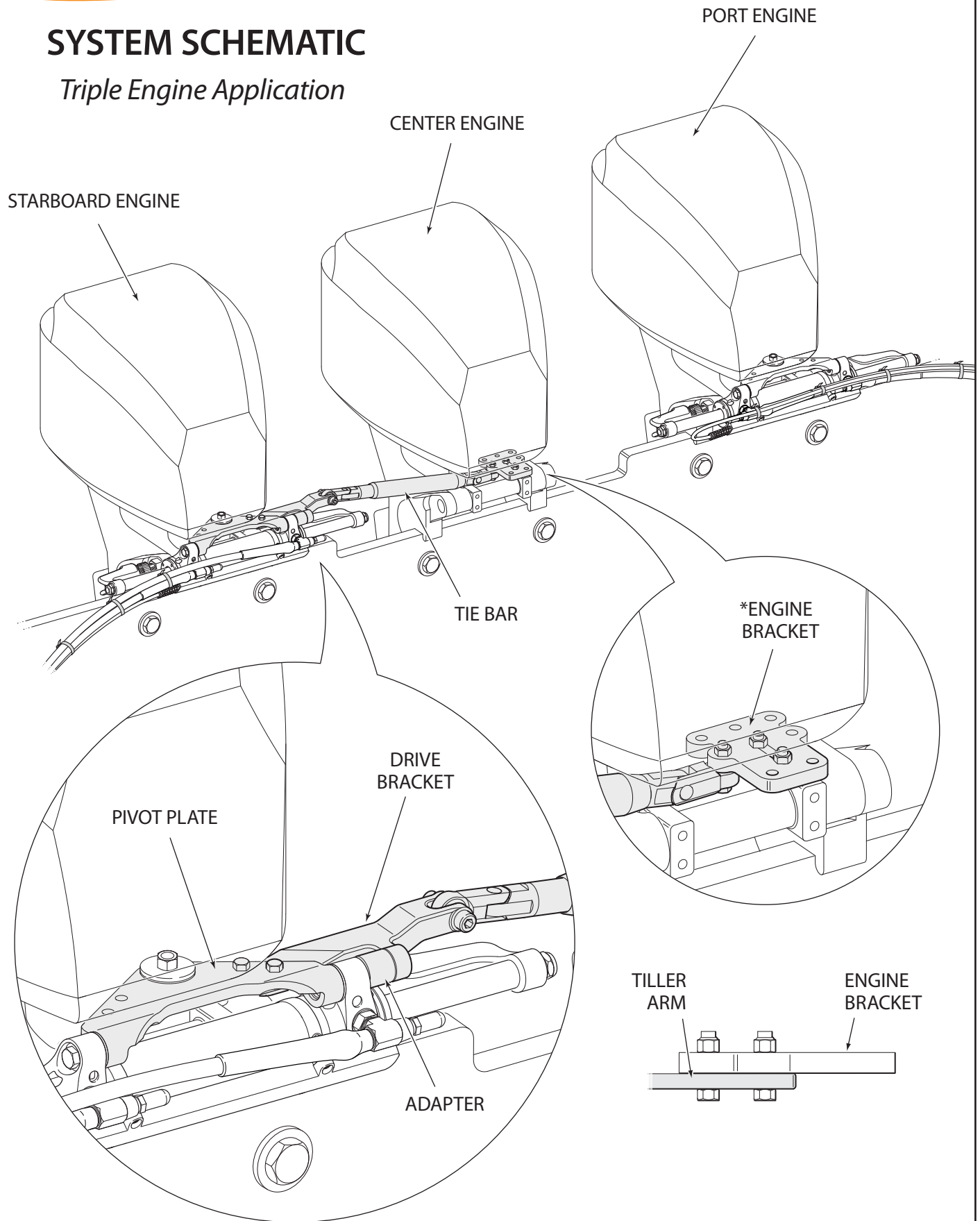

## SYSTEM SCHEMATIC

### Quad Engine Application

