

**SEASTAR™**

**KICKER CABLE TIE BAR**

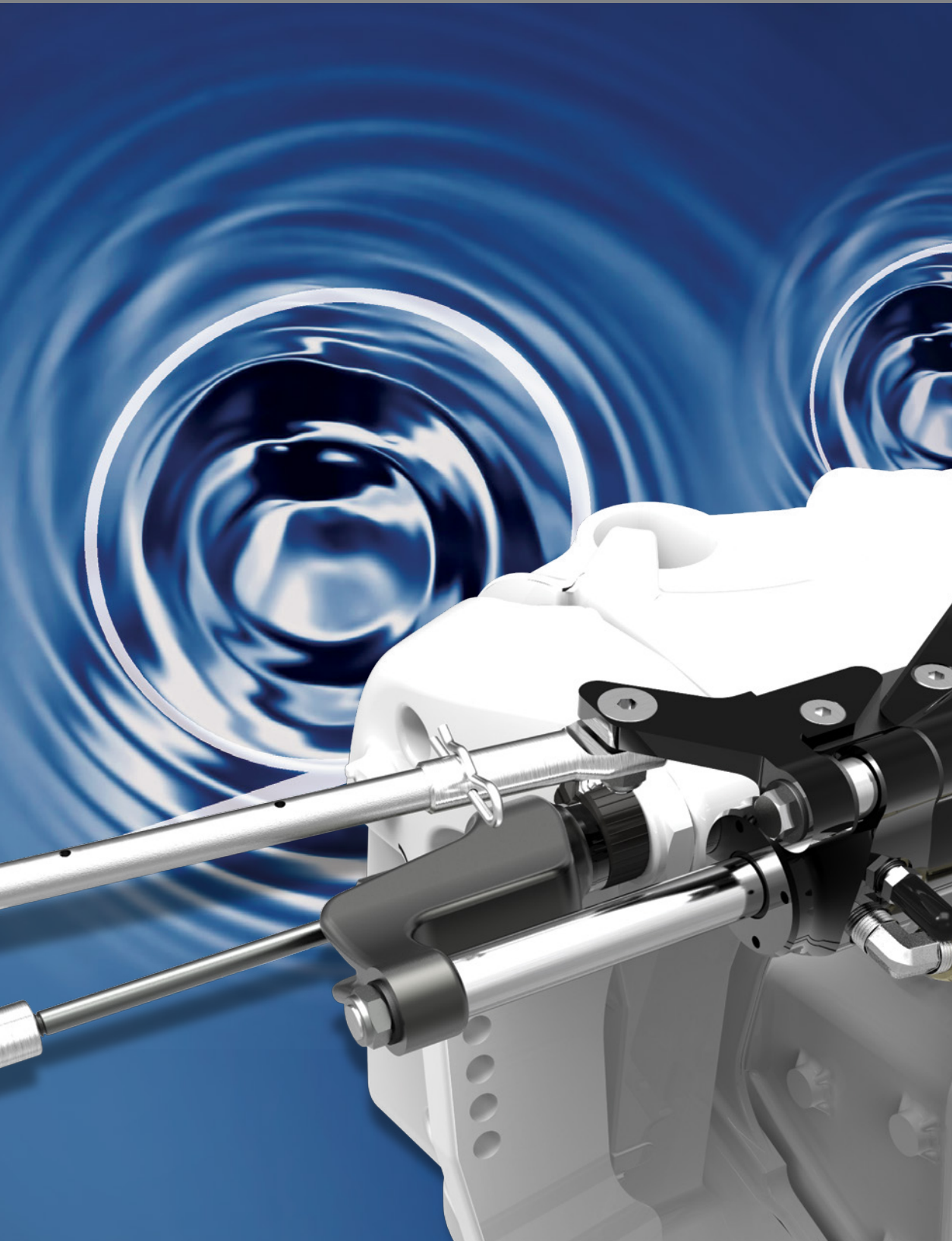

**SIMPLE ADDITION FOR AUXILIARY CONTROL**



This new SeaStar product allows a user to manually steer an auxiliary engine (kicker motor) using their existing SeaStar hydraulic steering system. Today this is accomplished with a variety of solid mechanical linkages between the main engine and the auxiliary engine. SeaStar has developed a patent pending design that incorporates an Xtreme cable as the linkage between the two engines.

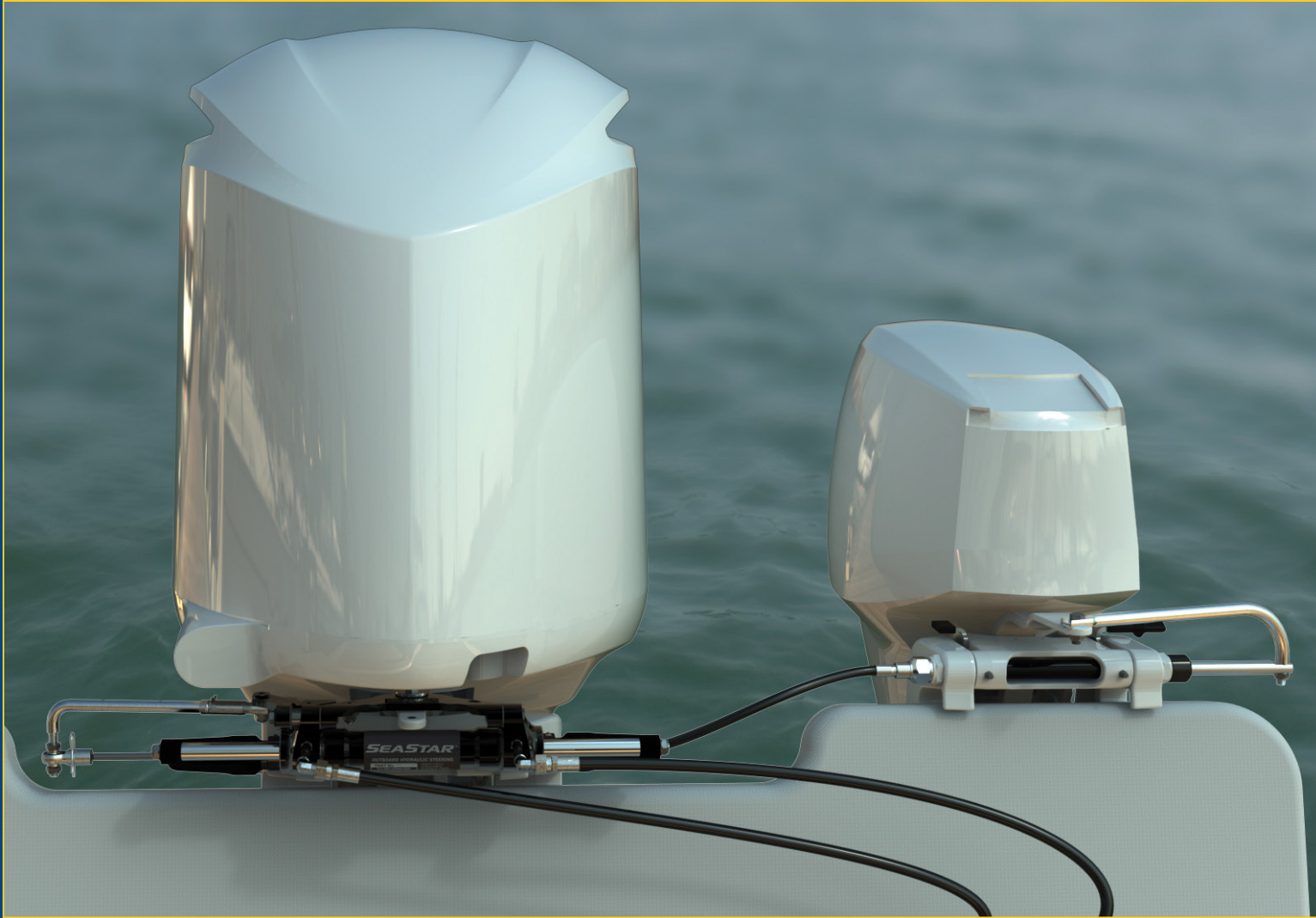

PART NUMBER	MAX ENGINE HORSEPOWER	CABLE LENGTH (NOMINAL)	CABLE TYPE
HO6116	20HP	16 inches	Xtreme 40 series
HO6122	20HP	22 inches	Xtreme 40 series
HO6128	20HP	28 inches	Xtreme 40 series
HO6134	20HP	34 inches	Xtreme 40 series
HO6144	20HP	44 inches	Xtreme 40 series

**Installation Notes:**

Kicker Cable Tie Bar systems require a minimum clearance of 14" from the end of the tilt tube towards the motor side well or gunnel. All systems shown are for port side kicker engine installations. Consult factory for starboard side installations.

*NOT for use with BayStar steering systems. The Kicker Cable Tiebar will ONLY work with SeaStar HC5345, HC5358 and HC5348 steering cylinders.*

## KIT CONTENTS

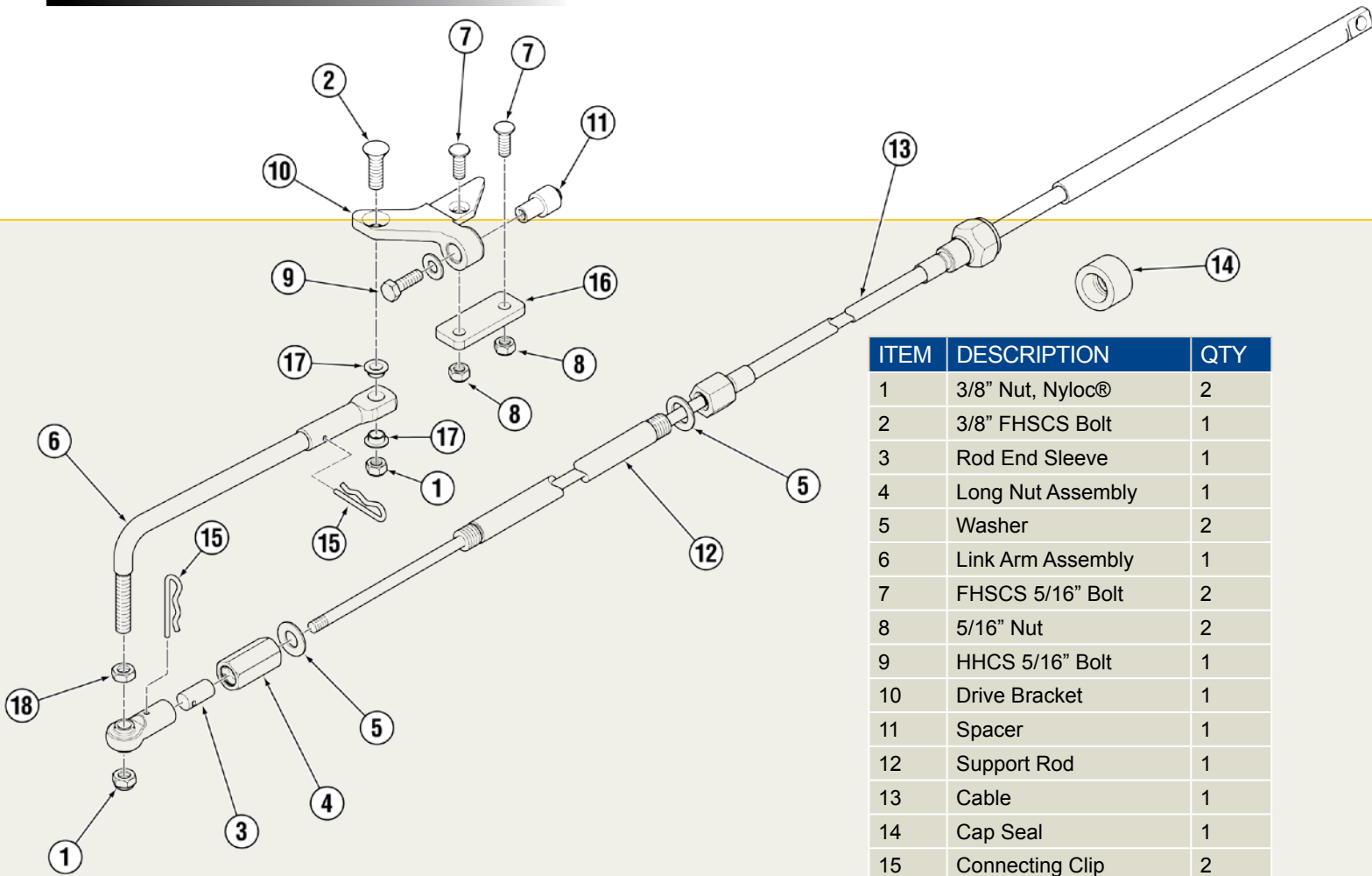

ITEM	DESCRIPTION	QTY
1	3/8" Nut, Nyloc®	2
2	3/8" FHSCS Bolt	1
3	Rod End Sleeve	1
4	Long Nut Assembly	1
5	Washer	2
6	Link Arm Assembly	1
7	FHSCS 5/16" Bolt	2
8	5/16" Nut	2
9	HHCS 5/16" Bolt	1
10	Drive Bracket	1
11	Spacer	1
12	Support Rod	1
13	Cable	1
14	Cap Seal	1
15	Connecting Clip	2
16	Drive Plate	1
17	Brass Bushing	2
18	3/8" Nut	1

## KICKER CABLE TIE BAR SELECTION WITH MOTOR BRACKET

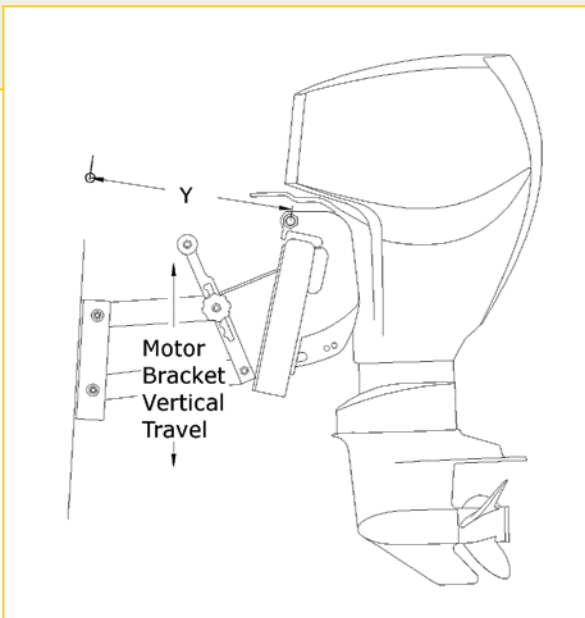

Table A

MOTOR BRACKET VERTICAL TRAVEL	ADD TO X DIMENSION
10"-12"	X + 3"
13"	X + 4"
14"-15"	X + 5"
16"-20"	X + 6"

Note 1.

For a Kicker installed on a motor bracket with vertical travel, add additional length to X dimension (as per table A).

Note 2.

For Main engine installed on an adjustable Jackplate add an additional 2" to X dimension.

**KICKER CABLE TIE BAR SELECTION**

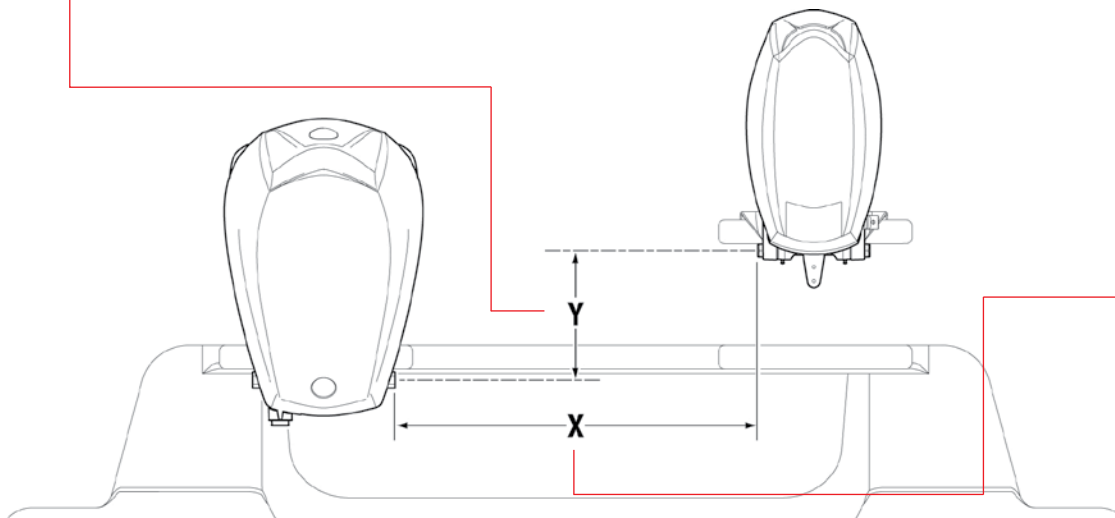
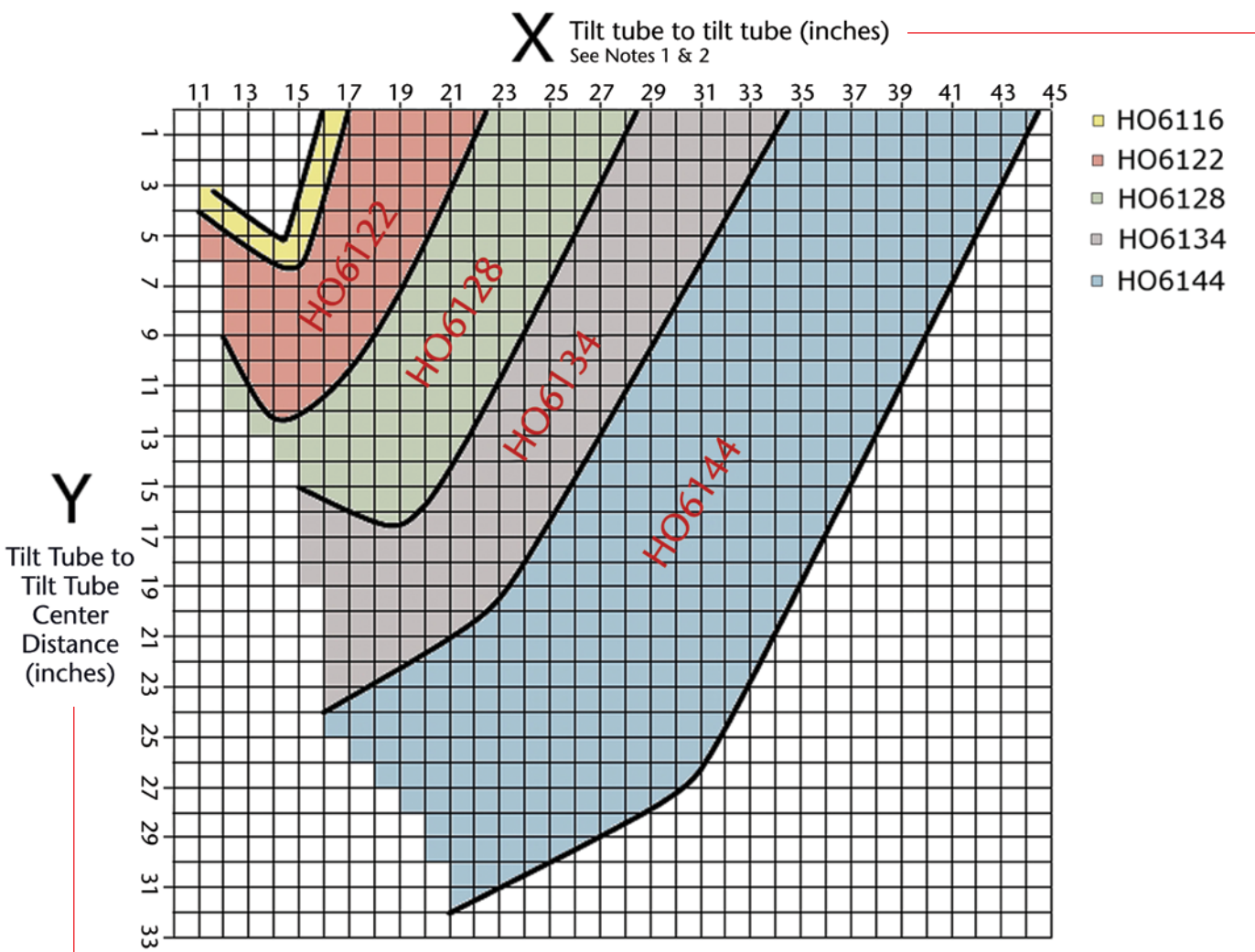

## Key features

- Flexible cable allows for adjustable locations of kicker motor.
- Allows independent trim/tilt of both engines.
- Allows full steering stroke of both engines.

- Simplified installation using universal ABYC steering connection (as per ABYC P17 & P21 standards) on kicker motor.
- Retrofittable to SeaStar Front Mount Cylinders
- Incorporates unique patented cable technology





©2014 SeaStar Solutions All Rights Reserved.  
Document: SeaStar Kicker Cable Tie Bar - 2014. Printed in the USA.

[www.seastarsolutions.com](http://www.seastarsolutions.com)