



POWER ASSIST INSTALLATION

⚠ WARNING

Whenever making electrical connections, you **MUST** ensure that the area is free and clear of fumes and/or flammable materials. Failure to adhere to this warning may result in an explosion and/or fire.

Power Assist Removal

NOTICE

Ensure that **NO** debris or contaminants enter the steering lines.

1. Ensure Power Assist is turned OFF.
2. Disconnect power to Power Assist Unit by disconnecting main power harness from battery, removing the fuse or by turning OFF the breaker.
3. Mark and disconnect ALL hoses from the Power Assist Pump.
4. Remove rear cover from Power Assist Unit.
5. Disconnect bottom Red (+) and Black (-) wires located on the inside of the Power Assist Unit (see Figure A1).
6. Loosen harness nut on side of Power Assist Unit.
7. Remove power harness from Power Assist Unit.
8. Disconnect the ignition wire connector (item 1) from unit. Loosen strain relief nut (item 2) on the ignition then remove the strain relief fitting itself from the electronics housing. Pull the ignition wire out and clear
9. Remove ALL mounting hardware and remove Power Assist Unit.

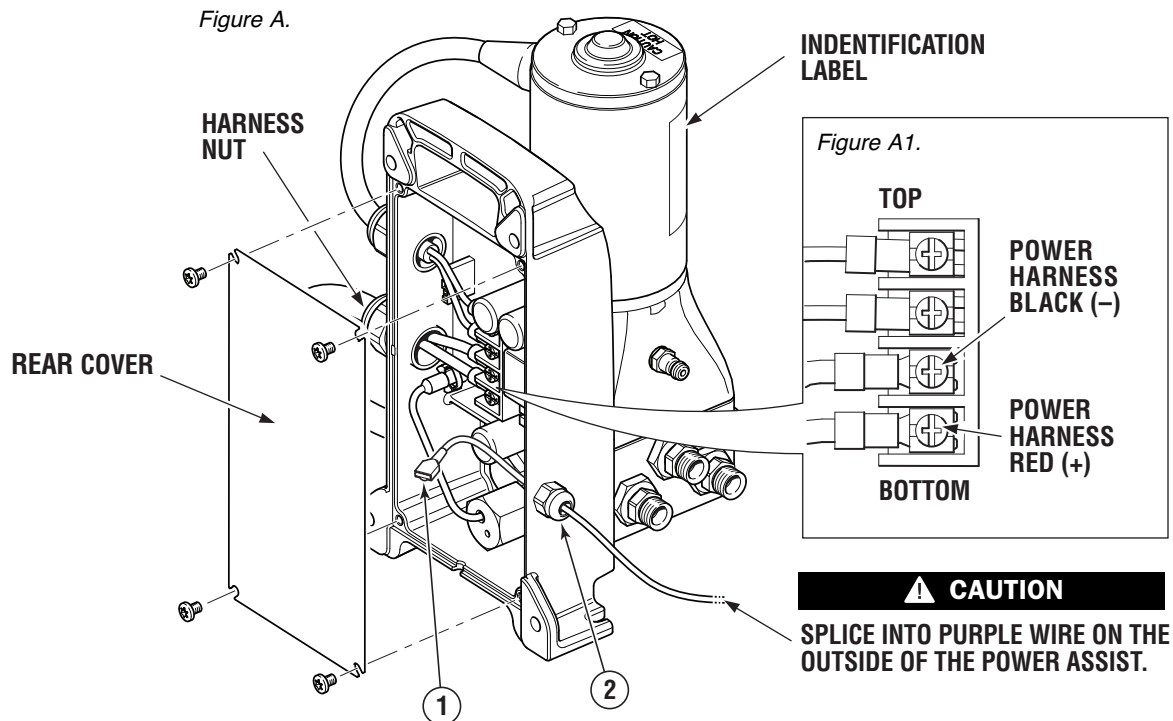

⚠ CAUTION

All electrical connections must be made as per ABYC.



Rebuilt Power Assist Install

1. Install power harness through harness nut and connect Black (-) and Red (+) battery leads to new Power Assist Unit as shown in Figure A1. Tighten harness nut
2. Re-install rear cover to the Power Assist Unit and torque each screw to 10 in. lb.
3. Splice purple wire on new Power Assist Unit to the old purple wire already installed on boat.
4. Securely mount Power Assist Unit to boat.
5. Reinstall fuse or reset breaker to restore power to the Power Assist Unit as required.
6. Re-connect steering hoses as per the markings that you made during removal.
7. Bleed steering system as outlined in your installation manual, or online at seastarsteering.com
8. Confirm proper operation of the Power Assist Unit.