

BAYSTAR™

CYLINDER MOUNTING PLATE FLIP

If your application requires the steering cylinder mounting plate to be flipped, you **MUST** add a small amount of a 'medium grade' thread locker (such as Loctite® 243) onto the threads of the 4 cap screws (see Figure A).

⚠ WARNING

Failure to apply the correct thread locker may result in separation of steering components. Separation of steering components may lead to loss of steering control. Loss of steering control may result in ejection from boat and/or a collision with an obstacle, leading to property damage, personal injury and/or death.

NOTICE

MUST use a medium strength thread locker on cap screws if removed and reassembled.

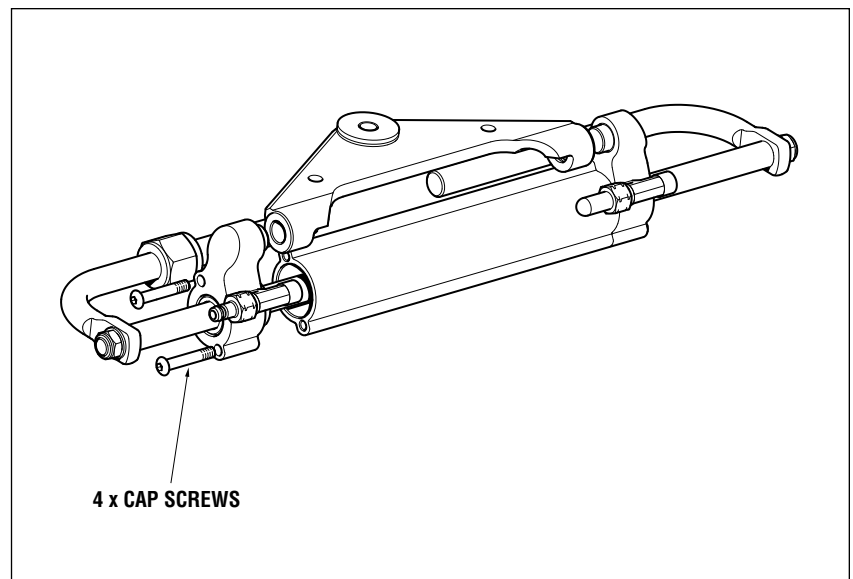

Figure A.