

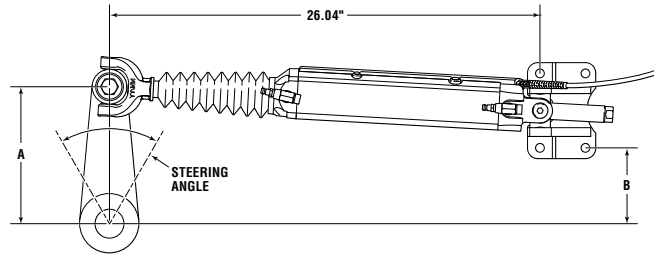

For Yachts 58ft to 75ft

MOUNTING CONFIGURATIONS & SYSTEM SCHEMATIC

While using the table below be sure that your steering cylinder is at mid-stroke as shown in the figure right to ensure the cylinder operates correctly.



Cylinder at mid-stroke.

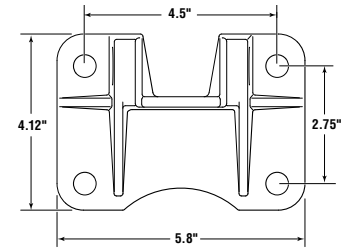

Mounting foot.

| Model EC5810 | | | |
|-----------------|-------|---------------|-------|
| STEERING ANGLES | | | |
| 50° | | 60° | |
| A | B | A | B |
| 11.27" | 7.96" | 9.50" | 5.98" |
| 56,300 in-lbs | | 45,400 in-lbs | |

| STEERING ANGLES | | | |
|-----------------|-------|---------------|-------|
| 70° | | 80° | |
| A | B | A | B |
| 8.25" | 4.50" | 7.40" | 3.41" |
| 37,400 in-lbs | | 31,200 in-lbs | |

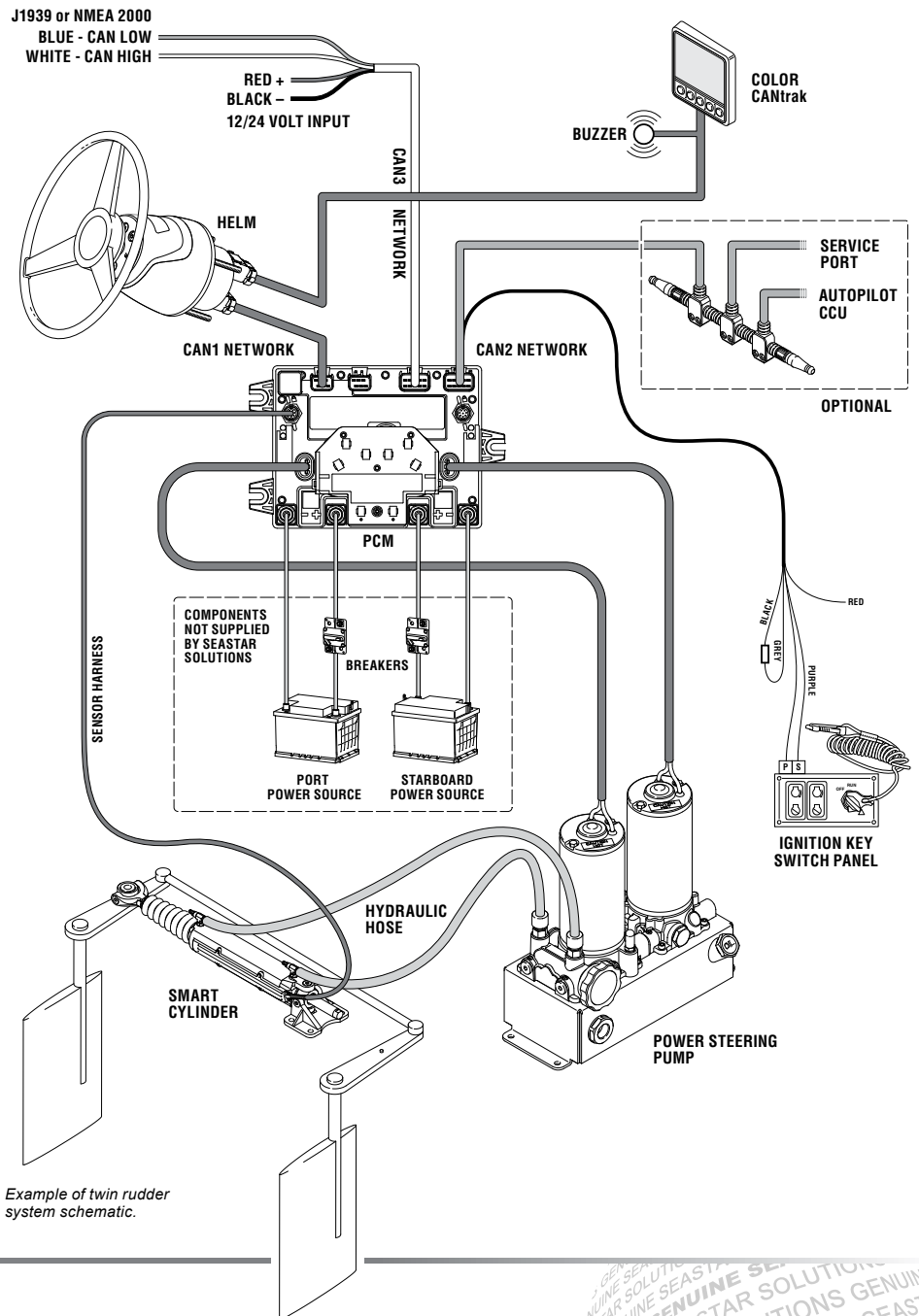

Example of twin rudder system schematic.

Issue Date - January 2017
Issue Number - 469256A

